

PRESTIGE

Line

PERFECT SYMBIOSIS

OF DESIGN

AND WARMTH

TELEPEP

LINA TOP

Airtight, ventilated pellet stove

PRESTIGE

Line

New 2023

A+ | 7,0** kW-N | 201** m³

CHARACTERISTICS



- Output smoke outlet possibilities: rear, upper
- Radiant surface heat exchanger
- Extractable burn pot for easy cleaning
- Easy Control
- Easy Setup

ECODESIGN**



TECHNICAL DATA

Nominal power (min-max)
2,5 - 7,0 kW-N**

Efficiency (min-max)
94,3 - 90,4 %**

Hourly consumption (min-max)
0,6 - 1,6 kg/h**

Dimensions (LxHxD)
478 x 914 x 522 mm**

Net weight
86 kg**

Fumes flue diameter (Ø)
80 mm U/R **

Tank total capacity
~11 kg / ~18 l

Power absorption (min-max)
30 - 60 W**

TECHNOLOGY



COLOUR CHOICES

High temperature painted steel covering



Black

STANDARD EQUIPMENT



REMOTE CONTROL
Backlit IR touch remote control



BLACK LCD

** Technical data may be subject to changes, approval pending

A+ | 7,0 kW-N | 201 m³

CHARACTERISTICS



- Output smoke outlet possibilities: rear
- Radiant surface heat exchanger
- Ergonomic handle
- Extractable burn pot for easy cleaning

ECODESIGN



Download
Technical Sheet



SCAN ME

TECHNICAL DATA

Nominal power (min-max)
2,5 - 7,0 kW-N

Efficiency (min-max)
92,2 - 90,9 %

Hourly consumption (min-max)
0,6 - 1,6 kg/h

Dimensions (LxHxD)
456 x 924 x 555 mm

Net weight
86 kg

Fumes flue diameter (Ø)
80 mm B

Tank total capacity
~15 kg / ~24 ℓ

Power absorption (min-max)
30 - 60 W

TECHNOLOGY

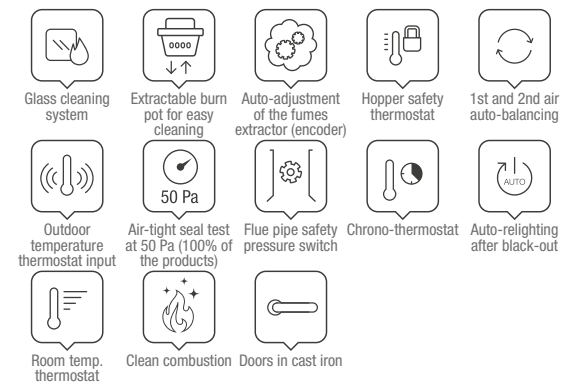

COLOUR CHOICES

High temperature painted steel covering



Ivory

Black

Bronze

STANDARD EQUIPMENT



REMOTE CONTROL
Backlit IR touch remote control



BLACK LCD

MOIRA EVO

Airtight, ventilated pellet stove

PRESTIGE

Line

A+ | 7,0 kW-N | 200 m³

CHARACTERISTICS



- Output smoke outlet possibilities: rear
- Emergency module
- Extractable burn pot for easy cleaning

ECODESIGN



Download
Technical Sheet



SCAN ME



TECHNICAL DATA

Nominal power (min-max)
2,5 - 7,0 kW-N

Efficiency (min-max)
94,3 - 90,4 %

Hourly consumption (min-max)
0,6 - 1,6 kg/h

Dimensions (LxHxD)
463 x 893 x 528 mm

Net weight
84 kg

Fumes flue diameter (Ø)
80 mm B

Tank total capacity
~11 kg / ~18 l

Power absorption (min-max)
30 - 60 W

TECHNOLOGY



COLOUR CHOICES

High temperature painted steel covering and majolica top cover



White

Black

STANDARD EQUIPMENT

REMOTE CONTROL

Control with radio-controlled "hand-held" device, with thermostat function



A+ | 7,0 kW-N | 201 m³

CHARACTERISTICS



- Smoke discharge outlet option: rear
- Removable brazier for easy cleaning
- Removable ash compartment
- Room temperature control with AUTOMATIC function
- Home automation integration with "Alexa"
- Easy Control
- Self Control
- Easy Setup



Tab for opening the door

ECODESIGN



Download technical data sheet



SCAN ME

TECHNICAL DATA

Nominal power (min. - max.)

2,5 - 7,0 kW-N

Efficiency (min. - max.)

94,3 - 90,4 %

Hourly consumption (min. - max.)

0,6 - 1,6 kg/h

Dimensions (WxHxD)

506 x 886 x 560 mm

Net weight

91 kg

Smoke outlet diameter (Ø)

80 mm R

Total tank capacity

~11 kg / ~18 l

Electric consumption (min. - max.)

26 - 58 W

TECHNOLOGY



Glass cleaning system



Removable brazier for easy cleaning



Self-adjusting smoke extractor (encoder)



Primary and secondary air self-balancing



External ambient thermostat connection



Airtightness test at 50 Pa (100% products)



Flue safety pressure switch



Programmable thermostat



Automatic reignition after blackout



Ambient temperature thermostat



Clean combustion



Cast iron doors

FINISHES

Painted steel two-tone cladding



White



Bronze



Black

STANDARD EQUIPMENT

REMOTE CONTROL

Control with radio-controlled "hand-held" device, with thermostat function



DISPLAY WITH BUILT-IN WI-FI

("Total Control 3.0" app)



A+ | 8,0 kW-N | 230 m³

CHARACTERISTICS



- Smoke discharge outlet option: rear, upper
- New “5-star” brazier + EGR
- Radiant surface heat exchanger
- Removable ash compartment
- Home automation integration with “Alexa” (Amazon). N.B. only with “Grey label” WiFi module – optional – and using the App Total Control 3.0. Service and “Alexa” device (Amazon) not included
- FPC – An innovative adaptive system for regulating and maintaining air combustion constant over time
- Easy Control
- Self Control
- Easy Setup

ECODESIGN



Download technical data sheet



SCAN ME

TECHNICAL DATA

Nominal power (min. - max.)

3,2 - 8,0 kW-N

Efficiency (min. - max.)

92,4 - 91,1 %

Hourly consumption (min. - max.)

0,7 - 1,8 kg/h

Dimensions (WxHxD)

496 x 1014 x 585 mm

Net weight

104 kg

Smoke outlet diameter (Ø)

80 mm U/R

Total tank capacity

~15 kg / ~24 ℓ

Electric consumption (min. - max.)

30 - 60 W

TECHNOLOGY



Glass cleaning system



Removable brazier for easy cleaning



Self-adjusting smoke extractor (encoder)



Tank safety thermostat



Primary and secondary air self-balancing



External ambient thermostat connection



Airtightness test at 50 pa (100% products)



Flue safety pressure switch



Programmable thermostat



Automatic reignition after blackout



Ambient temperature thermostat



Clean combustion



Cast iron doors

FINISHES

Black painted steel cladding and ceramic or stone front panel



Black



Tortora



Natural stone

STANDARD EQUIPMENT



REMOTE CONTROL

Backlit IR Touch remote control



BLACK LCD

A+ | 8,0 kW-N | 230 m³

CHARACTERISTICS



- Removable brazier for easy cleaning
- Removable ash compartment
- Room temperature control with AUTOMATIC function
- Home automation integration with "Alexa"
- Easy Setup
- Easy Control
- Self Control

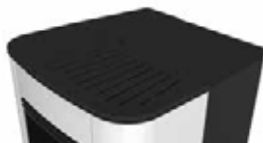

Thick top

ECODESIGN



Download technical data sheet



SCAN ME

TECHNICAL DATA

Nominal power (min. - max.)

2,5 - 8,0 kW-N

Efficiency (min. - max.)

94,7 - 91,5 %

Hourly consumption (min. - max.)

0,5 - 1,8 kg/h

Dimensions (WxHxD)

507 x 1007 x 558 mm

Net weight

101 kg

Smoke outlet diameter (Ø)

80 mm R

Total tank capacity

~15 kg / ~24 ℓ

Electric consumption (min. - max.)

25 - 60 W

TECHNOLOGY



Glass cleaning system



Removable brazier for easy cleaning



Self-adjusting smoke extractor (encoder)



Tank safety thermostat



Primary and secondary air self-balancing



External ambient thermostat connection



Airtightness test at 50 pa (100% products)



Flue safety pressure switch



Programmable thermostat



Automatic reignition after blackout



Ambient temperature thermostat



Clean combustion



Cast iron doors

FINISHES

Painted steel cladding



White



Black

STANDARD EQUIPMENT



REMOTE CONTROL

Control with radio-controlled "hand-held" device, with thermostat function



DISPLAY WITH BUILT-IN WI-FI

("Total Control 3.0" app)

ANGELA EVO

 Ventilated and **hermetic** pellet stove

PRESTIGE

Line

A+ | 8,0 kW-N | 230 m³

CHARACTERISTICS



- Output smoke outlet possibilities: rear
- Emergency module
- Extractable burn pot for easy cleaning

ECODESIGN



Download
Technical Sheet



SCAN ME

TECHNICAL DATA

Nominal power (min-max)
2,5 - 8,0 kW-N

Efficiency (min-max)
94,7 - 91,5 %

Hourly consumption (min-max)
0,5 - 1,8 kg/h

Dimensions (LxHxD)
490 x 1007 x 528 mm

Net weight
93 kg

Fumes flue diameter (Ø)
80 mm B

Tank total capacity
~15 kg / ~24 ℓ

Power absorption (min-max)
25 - 60 W

TECHNOLOGY

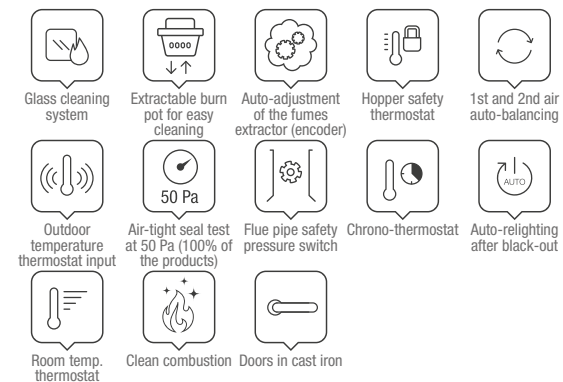

COLOUR CHOICES

High temperature painted steel covering and majolica top cover



Black

White

STANDARD EQUIPMENT

REMOTE CONTROL

Control with radio-controlled "hand-held" device, with thermostat function



PAMELA STEEL

 Ventilated and **hermetic** pellet stove

PRESTIGE

Line

A+ | 8,0 kW-N | 230 m³

CHARACTERISTICS



- Output smoke outlet possibilities: rear aligned
- Hearth, door fire and brazier in cast iron
- Emergency module
- Extractable burn pot for easy cleaning
- Extractable Ash compartment

ECODESIGN



Download
Technical Sheet



SCAN ME

TECHNICAL DATA

Nominal power (min-max)

2,5 - 8,0 kW-N

Efficiency (min-max)

92,6 - 91,2 %

Hourly consumption (min-max)

0,6 - 1,8 kg/h

Dimensions (LxHxD)

470 x 1197 x 470 mm

Net weight

130 kg

Fumes flue diameter (Ø)

80 mm B

Tank total capacity

~15 kg / ~24 ℓ

Power absorption (min-max)

28 - 67 W

TECHNOLOGY

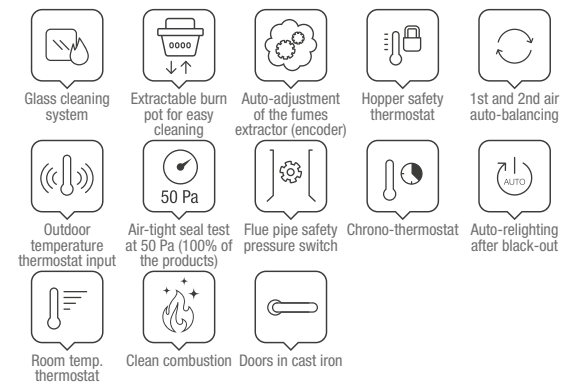

COLOUR CHOICES

High temperature painted steel covering



Bronze

Tortora

STANDARD EQUIPMENT

REMOTE CONTROL

Control with radio-controlled "hand-held" device, with thermostat function



OPTIONAL



Kit Glass Night View ROBAX®

PAMELA CRYSTAL - BLSC

E Airtight, ventilated pellet stove

PRESTIGE
Line

A+ | 8,0 kW-N | 230 m³

CHARACTERISTICS



- Smoke discharge outlet option: rear on axis
- Cast iron door, hearth and brazier
- Emergency module
- Removable brazier for easy cleaning
- Removable ash compartment



ECODESIGN



Download
technical data sheet



SCAN ME

TECHNICAL DATA

Nominal power (min. - max.)

2,5 - 8,0 kW-N

Efficiency (min. - max.)

92,6 - 91,2 %

Hourly consumption (min. - max.)

0,6 - 1,8 kg/h

Dimensions (WxHxD)

470 x 1197 x 470 mm

Net weight

140 kg

Smoke outlet diameter (Ø)

80 mm R

Total tank capacity

~15 kg / ~24 ℓ

Electric consumption (min. - max.)

28 - 67 W

TECHNOLOGY



Glass cleaning system



Removable brazier for easy cleaning



Self-adjusting smoke extractor (encoder)



Tank safety thermostat



Primary and secondary air self-balancing



External ambient thermostat connection



Airtightness test at 50 pa (100% products)



Flue safety pressure switch



Programmable thermostat



Automatic reignition after blackout



Ambient temperature thermostat



Clean combustion



Cast iron doors

FINISHES

Tempered glass cladding



Crystal BLSC

STANDARD EQUIPMENT



REMOTE CONTROL

Control with radio-controlled "hand-held" device, with thermostat function

A+ | 9,0 kW-N | 258 m³

CHARACTERISTICS



- Shell and tube exchanger
- T tube integrated in the product, inspectable from the rear
- Hearth, door fire and brazier in cast iron
- Emergency module
- Extractable burn pot for easy cleaning
- Extractable ash drawer

ECODESIGN



Download
Technical Sheet



SCAN ME

TECHNICAL DATA

Nominal power (min-max)
3,8 - 9,0 kW-N

Efficiency (min-max)
92,2 - 92,7 %

Hourly consumption (min-max)
0,9 - 2,0 kg/h

Dimensions (LxHxD)
550 x 1200 x 573 mm

Net weight
141 kg
PT 167 kg

Fumes flue diameter (Ø)
80 mm B/T

Tank total capacity
~18 kg / ~29 ℓ

Power absorption (min-max)
24 - 62 W

TECHNOLOGY

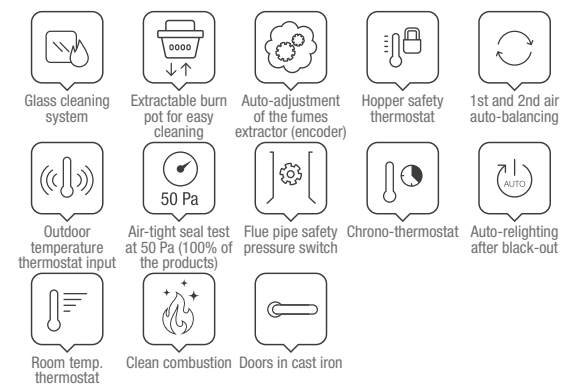

COLOUR CHOICES

High temperature painted steel covering and majolica top cover or natural stone



White

Black

Natural stone (PT)

STANDARD EQUIPMENT



REMOTE CONTROL
Control with radio-controlled "hand-held" device, with thermostat function

OPTIONAL



Kit Glass Night View ROBAX®

MIRKA PLUS

Ducted pellet stove

PRESTIGE

Line

A+ | 8,0 kW-N | 230 m³

CHARACTERISTICS



- Smoke discharge outlet option: rear, upper
- New "5-star" brazier + EGR
- Ducting with dedicated motor up to 8 metres, thermostatically controlled and removable + AIR ZONE CONTROL
- Radiant surface heat exchanger
- Removable ash compartment
- Home automation integration with "Alexa" (Amazon). N.B. only with "Grey label" WiFi module – optional – and using the App Total Control 3.0. Service and "Alexa" device (Amazon) not included
- FPC – An innovative adaptive system for regulating and maintaining air combustion constant over time
- Easy Control
- Self Control
- Easy Setup

 UP TO 8 METRES OF DUCTS through one back output Ø80 (excludable)

ECODESIGN



Download technical data sheet



SCAN ME

TECHNICAL DATA

Nominal power (min. - max.)

3,2 - 8,0 kW-N

Efficiency (min. - max.)

92,5 - 91,0 %

Hourly consumption (min. - max.)

0,7 - 1,8 kg/h

Dimensions (WxHxD)

496 x 1014 x 585 mm

Net weight

108 kg

Smoke outlet diameter (Ø)

80 mm U/R

Total tank capacity

~15 kg / ~24 l

Electric consumption (min. - max.)

45 - 96 W

TECHNOLOGY

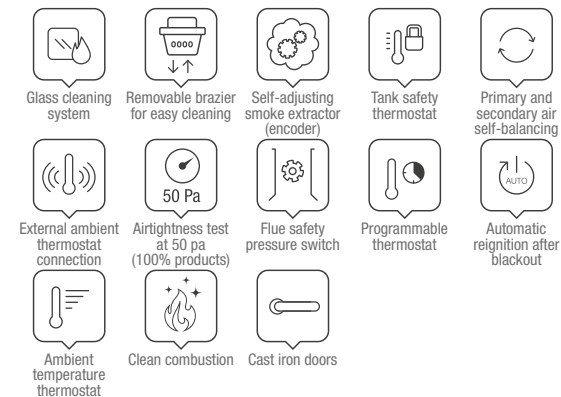

FINISHES

Black painted steel cladding and ceramic or stone front panel



Black

Tortora

Natural stone

STANDARD EQUIPMENT



REMOTE CONTROL
Backlit IR Touch remote control



BLACK LCD

ANGELA PLUS EVO

E Hermetic pellet stove with ducting system

PRESTIGE
Line

A+ | 8,0 kW-N | 230 m³

CHARACTERISTICS



- Output smoke outlet possibilities: rear
- Ducting system output possibilities (Ø80 mm): rear
- Emergency module
- Extractable burn pot for easy cleaning
- Extractable Ash compartment

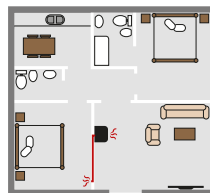

UP TO 8 METRES OF DUCTS through one back output Ø80 (excludable)

ECODESIGN



Download
Technical Sheet



SCAN ME

TECHNICAL DATA

Nominal power (min-max)
2,5 - 8,0 kW-N

Efficiency (min-max)
94,9 - 91,9 %

Hourly consumption (min-max)
0,5 - 1,8 kg/h

Dimensions (LxHxD)
490 x 1007 x 528 mm

Net weight
98 kg

Fumes flue diameter (Ø)
80 mm B

Tank total capacity
~15 kg / ~24 ℓ

Power absorption (min-max)
50 - 80 W

TECHNOLOGY



Glass cleaning system



Extractable burn pot for easy cleaning



Auto-adjustment of the fumes extractor (encoder)



Hopper safety thermostat



1st and 2nd air auto-balancing



Outdoor temperature thermostat input



Air-tight seal test at 50 Pa (100% of the products)



Flue pipe safety pressure switch



Chrono-thermostat



Auto-re-lighting after black-out



Room temp. thermostat



Clean combustion



Doors in cast iron

COLOUR CHOICES

High temperature painted steel covering and majolica top cover



White



Black

STANDARD EQUIPMENT



REMOTE CONTROL
Control with radio-controlled "hand-held" device, with thermostat function

ILARY PLUS

E Airtight, ducted pellet stove

PRESTIGE
Line

A+ | 8,0 kW-N | 230 m³

CHARACTERISTICS



- Removable brazier for easy cleaning
- Removable ash compartment
- Shell and tube heat exchanger
- Ducting with dedicated motor up to 8 metres, thermostatically controlled and removable + AIR ZONE CONTROL
- Room temperature control with AUTOMATIC function
- Home automation integration with "Alexa"
- Easy Setup
- Easy Control
- Self Control

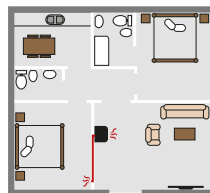

UP TO 8 METRES OF DUCTS
through one back output Ø80
(excludable)

ECODESIGN



Download
technical data sheet



SCAN ME

TECHNICAL DATA

Nominal power (min. - max.)

2,5 - 8,0 kW-N

Efficiency (min. - max.)

94,9 - 91,9 %

Hourly consumption (min. - max.)

0,5 - 1,8 kg/h

Dimensions (WxHxD)

507 x 1007 x 558 mm

Net weight

105 kg

Smoke outlet diameter (Ø)

80 mm R

Total tank capacity

~15 kg / ~24 ℓ

Electric consumption (min. - max.)

45 - 75 W

TECHNOLOGY



Glass cleaning system



Removable brazier for easy cleaning



Self-adjusting smoke extractor (encoder)



Tank safety thermostat



Primary and secondary air self-balancing



External ambient thermostat connection



Airtightness test at 50 pa (100% products)



Flue safety pressure switch



Programmable thermostat



Automatic reignition after blackout



Ambient temperature thermostat



Clean combustion



Cast iron doors

FINISHES

Painted steel cladding



White



Black

STANDARD EQUIPMENT



REMOTE CONTROL

Control with radio-controlled "hand-held" device, with thermostat function



DISPLAY WITH BUILT-IN WI-FI

("Total Control 3.0" app)

GABRIELLA PLUS

E Tight and **hermetic** pellet stove with ducting system

PRESTIGE
Line

A+ | 8,0 kW-N | 230 m³

CHARACTERISTICS



- Output smoke outlet possibilities: upper-backside, upper
- Extractable burn pot for easy cleaning
- Extractable Ash compartment



UP TO 8 METRES OF DUCTS through one back or left side output Ø80 (excludable)

ECODESIGN



Download
Technical Sheet



SCAN ME

TECHNICAL DATA

Nominal power (min-max)
3,5 - 8,0 kW-N

Efficiency (min-max)
94,1 - 94,0 %

Hourly consumption (min-max)
0,8 - 1,8 kg/h

Dimensions (LxHxD)
750 x 1077 x 350 mm

Net weight
132 kg
PT 160 kg

Fumes flue diameter (Ø)
80 mm B/T

Tank total capacity
~15 kg / ~24 ℓ

Power absorption (min-max)
50 - 90 W

TECHNOLOGY

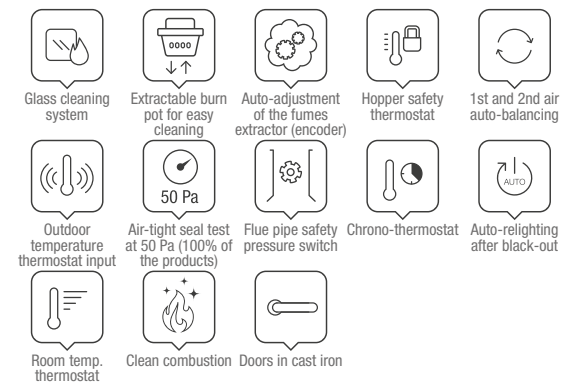

COLOUR CHOICES

High temperature painted steel covering or natural stone



White

Bronze

Natural stone (PT)

STANDARD EQUIPMENT



REMOTE CONTROL
Backlit IR touch remote control



BLACK LCD

DEBBY PLUS EVO

E Airtight, ducted pellet stove

PRESTIGE
Line

New 2023

A+ | 9,0 kW-N | 258 m³

CHARACTERISTICS

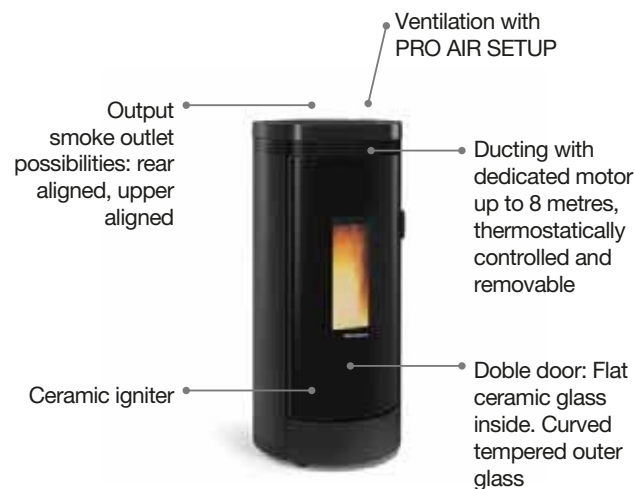

- Shell and tube exchanger
- T tube integrated in the product, inspectable from the rear
- Hearth, door fire and brazier in cast iron
- Safety button
- Extractable ash drawer
- FPC – An innovative adaptive system for regulating and maintaining air combustion constant over time
- FPC PLUS - besides the work carried out by FPC, it allows abnormal situations to be noted by setting the generator in safe conditions.
- With AIR ZONE CONTROL (AZC), the speed of rotation of the ducted fan is controlled in order to maximise the transmission of thermal power in the ducted environment.

ECODESIGN



Download
Technical Sheet



SCAN ME



TECHNICAL DATA

Nominal power (min-max)
3,8 - 9,0 kW-N

Efficiency (min-max)
92,2 - 92,7 %

Hourly consumption (min-max)
0,9 - 2,0 kg/h

Dimensions (LxHxD)
550 x 1200 x 573 mm

Net weight
141 kg
PT 167 kg

Fumes flue diameter (Ø)
80 mm B/T

Tank total capacity
~18 kg / ~29 ℓ

Power absorption (min-max)
24 - 62 W

TECHNOLOGY

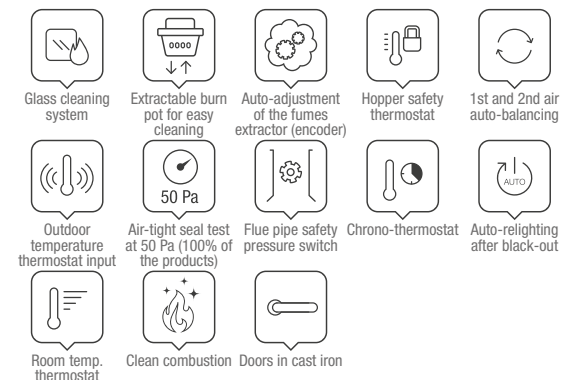

COLOUR CHOICES

High temperature painted steel covering and majolica top cover or natural stone



White

Black

Natural stone (PT)

STANDARD EQUIPMENT

REMOTE CONTROL

Control with radio-controlled "hand-held" device, with thermostat function



OPTIONAL



Kit Glass Night View ROBAX®

SHARON PLUS

 Tight and **hermetic** pellet stove with ducting system

PRESTIGE
Line

A+ | 10,0 kW-N | 287 m³

CHARACTERISTICS



- Extractable burn pot for easy cleaning
- Output smoke outlet possibilities: rear, upper
- Ducting system output possibilities (Ø80 mm): rear
- Radiant surface heat exchanger
- Double door: Glass ceramic external door
- Wide fire vision
- Reduced depth (slim)
- Emergency module
- Ash compartment
- Door fire and brazier in cast iron
- With the AUTOMATIC function activated, the stove manages the power output so that the room temperature set by the user remains constant. This minimises power fluctuations to the benefit of thermal and acoustic comfort
- With AIR ZONE CONTROL (AZC) the speed of rotation of the ducting fan is managed with the aim of maximising the transmission of thermal power in the ducted environment

ECODESIGN



Download
Technical Sheet



SCAN ME

TECHNICAL DATA

Nominal power (min-max)
3,5 - 10,0 kW-N

Efficiency (min-max)
91,7 - 91,0 %

Hourly consumption (min-max)
0,8 - 2,3 kg/h

Dimensions (LxHxD)
900 x 1150 x 290 mm

Net weight
155 kg - PT 167 kg

Fumes flue diameter (Ø)
80mm B/T

Tank total capacity
~21 kg / ~33 ℓ

Power absorption (min-max)
30 - 50 W

TECHNOLOGY

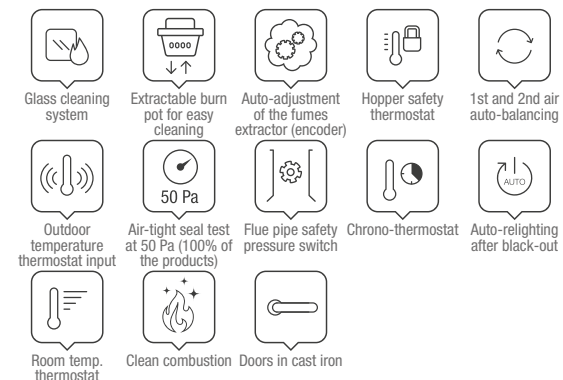

COLOUR CHOICES

Glass or natural stone covered



Crystal

Natural stone (PT)

STANDARD EQUIPMENT

REMOTE CONTROL

Control with radio-controlled "hand-held" device, with thermostat function



OPTIONAL

KIT DUCTING

Right side ducting kit



SHARON PLUS STEEL

E Airtight, ducted, slim pellet stove

PRESTIGE

Line

A+ | 10,0 kW-N | 287 m³

CHARACTERISTICS

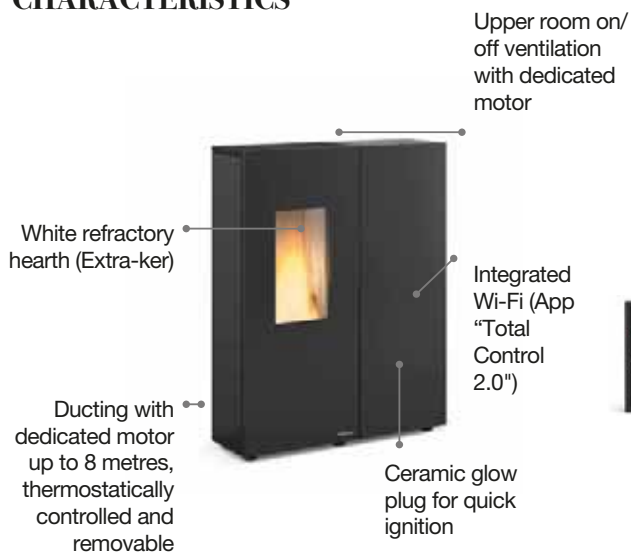

- Removable brazier for easy cleaning
- Smoke discharge outlet option: rear, upper
- Ducting outlet options (Ø80 mm): rear
- Radiant surface heat exchanger
- Double door
- Wide view of the flame
- Reduced depth
- Emergency module
- Ash compartment
- Cast iron door and brazier
- With the AUTOMATIC function activated, the stove manages the power output so that the room temperature set by the user remains constant. This minimises power fluctuations to the benefit of thermal and acoustic comfort
- With AIR ZONE CONTROL (AZC) the speed of rotation of the ducting fan is managed with the aim of maximising the transmission of thermal power in the ducted environment

ECODESIGN



Download technical data sheet



SCAN ME

TECHNICAL DATA

Nominal power (min. - max.)

3,5 - 10,0 kW-N

Efficiency (min. - max.)

91,7 - 91,0 %

Hourly consumption (min. - max.)

0,8 - 2,3 kg/h

Dimensions (WxHxD)

900 x 1150 x 295 mm

Net weight

155 kg

Smoke outlet diameter (Ø)

80 mm R/U

Total tank capacity

~21 kg / ~33 ℓ

Electric consumption (min. - max.)

30 - 50 W

TECHNOLOGY



Glass cleaning system



Removable brazier for easy cleaning



Self-adjusting smoke extractor (encoder)



Tank safety thermostat



Primary and secondary air self-balancing



External ambient thermostat connection



Airtightness test at 50 pa (100% products)



Flue safety pressure switch



Programmable thermostat



Automatic reignition after blackout



Ambient temperature thermostat



Clean combustion



Cast iron doors

FINISHES

Painted steel cladding



Black

STANDARD EQUIPMENT

REMOTE CONTROL

Control with radio-controlled "hand-held" device, with thermostat function



OPTIONAL

KIT DUCTING

Right side ducting kit



ROSANNA IDRO

E Hermetic and ventilated pellet thermo-stove

PRESTIGE
Line

A+ | 14,2 kW-N | 11,0 kW-H₂O | 407 m³

CHARACTERISTICS



- Pressure transducer and display pressure value indication
- Output smoke outlet possibilities: rear
- Safety valve 3 bar
- Combustion chamber in thick steel
- Air relief valve
- Ergonomic handle
- Door fire and brazier in cast iron
- Thermal and pressure safety
- Expansion tank
- Extractable ash drawer

ECODESIGN



Download
Technical Sheet



SCAN ME

TECHNICAL DATA

Nominal power (min-max)
4,1 - 14,2 kW-N

Power given back to water (min-max)
2,9 - 11,0 kW-H₂O

Efficiency (min-max)
92,9 - 91,1 %

Hourly consumption (min-max)
0,9 - 3,2 kg/h

Dimensions (LxHxD)
511 x 1150 x 632 mm

Net weight
163 kg

Fumes flue diameter (Ø)
100 mm B

Tank total capacity
~27 kg / ~43 ℓ

Power absorption (min-max)
65 - 95 W

Operating pressure (bar)
3 bar

TECHNOLOGY

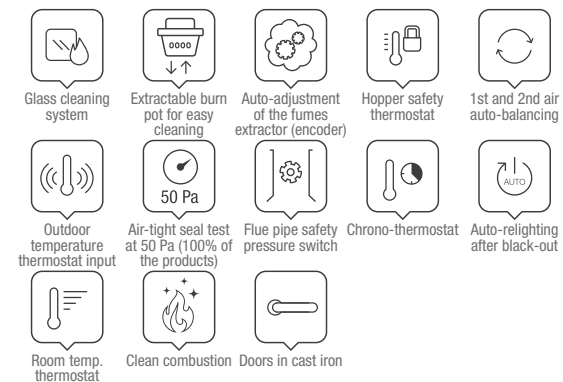

COLOUR CHOICES

High temperature painted steel covering and majolica top cover



STANDARD EQUIPMENT



REMOTE CONTROL
Backlit IR touch remote control



BLACK LCD